

**CONFIDENTIAL & PROPRIETARY**

All data contained in this document is sole property of **DRY SYSTEMS TECHNOLOGIES** and is considered confidential and proprietary. This document may not be reproduced, released to third parties, or used for purposes other than for which it was furnished, without express written consent of **DRY SYSTEMS TECHNOLOGIES**. This document remains property of **DRY SYSTEMS TECHNOLOGIES** and must be returned upon request.

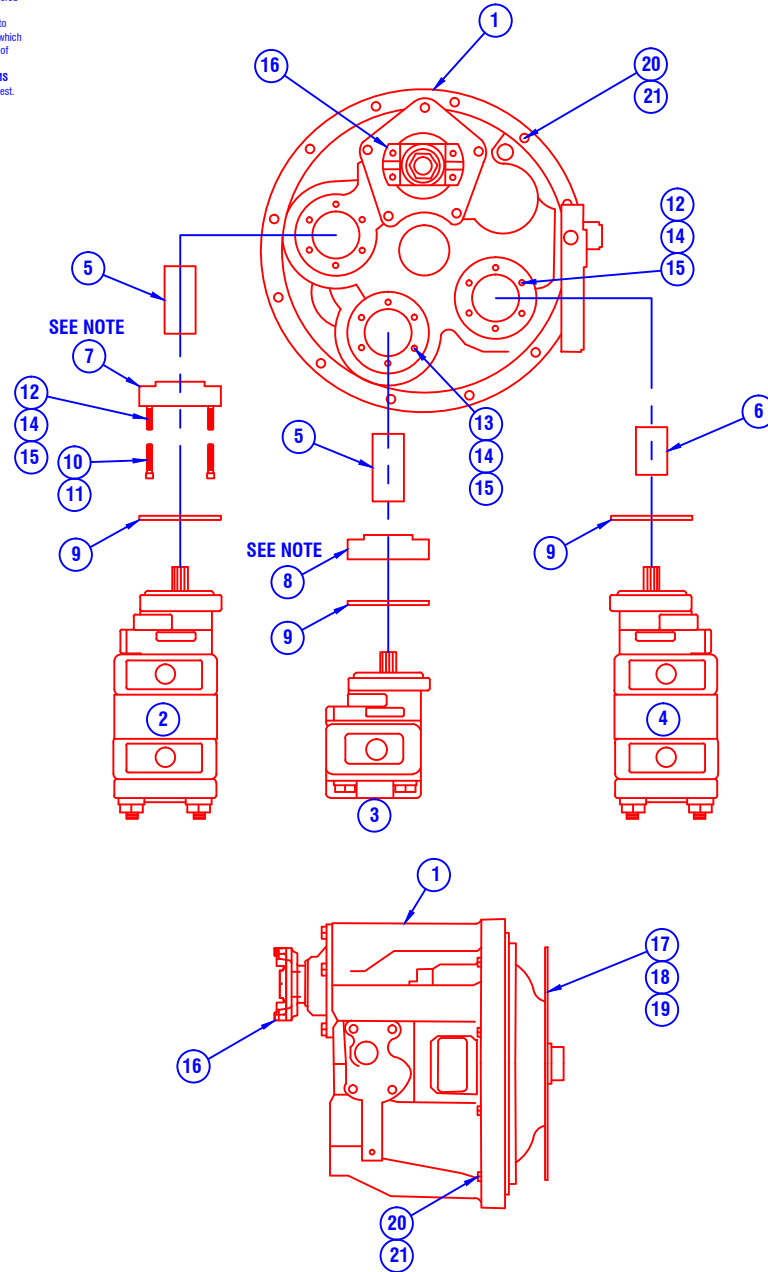

**NOTE: USE HI-TEMP SILICONE BETWEEN TORQUE CONVERTOR AND PUMP ADAPTERS NO. 7 & 8**

**SECTION 3-03**

TOLERANCES			
Linear unless noted			
Machined: ±0.005			
Fabricated: ±0.02			
Angular: ±1/2°			
Surface finish 125			

**DRY SYSTEMS TECHNOLOGIES**  
 10420 RISING COURT  
 WOODRIDGE, IL 60517  
 Phone: 630-427-2051 Fax: 630-427-1036  
 E-Mail: [enq@dryssystemtech.com](mailto:enq@dryssystemtech.com)

DESCRIPTION	NO. REQS.
TORQUE CONV. / HYD PUMP INSTALLATION	
SCALE: Full	DATE: APRIL 14 2015
DRAWN BY: W FOX	APPROVED BY:
MATERIAL:	
DRAWING NO:	<b>M350-500-04</b>

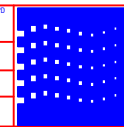

**TORQUE CONVERTOR / HYD PUMP INSTALLATION**

ITEM	PART NUMBER	QUAN.	DESCRIPTION	Notes
	M350-500-01		TORQUE CONVERTOR KIT	Includes # 1,4,5,6,17 &22
1	M350-500-04	1	TORQUE CONVERTOR	
2	M350-665-02	1	PUMP, HYD, TANDEM, 28/18 GPM	Steering / Brakes
3	M350-665-01	1	PUMP, HYD, MAIN, 28 GPM	
4	M350-500-02	1	PUMP, CHARGE & SCAVANGER	
5	M350-650-01	2	COUPLING ASSEMBLY	
6	M350-500-03	1	SLEEVE, CONVERTOR, CHARGE PUMP	
7	M350-660-02	1	ADAPTER, PUMP, 6 BOLT, OFFSET MOUNT	
8	M350-660-01	1	ADAPTER, PUMP, 6 BOLT	
9	M350-659-01	3	GASKET, PUMP, CONVERTOR, 6 BOLT	
10	M515-500-06	6	SOCKET HEAD CAPSCREW, 3/8-16 X 1 GR8	
11	M150-538-01	6	LOCK WASHER, HIGH COLLAR, 3/8	
12	M515-590-01	12	STUD, 3/8-24 X 3/4 - 3/8-16 X 1/2 1 1/2 OAL GR8	
13	M515-590-02	6	STUD, 3/8-24 X 1 - 3/8-16 X 3/4 2 3/4 OAL GR8	
14	M600-109-01	18	NUTS, 3/8	
15	M600-123-01	18	LOCK WASHER, 3/8	
16	M507-655-01	1	YOKE, OUTPUT, 6C	
17	M500-538-01	1	FLEX PLATE KIT	
18	M515-500-20	8	HEX HEAD CAPSCREW, 3/8-24 X 1 1/2 GR8	Flex Plate to Flywheel
19	M515-530-02	8	NORD LOCK WASHERS, 3/8	Flex Plate to Flywheel
20	M515-500-07	12	HEX HEAD CAPSCREW, M10-1.5 X 60 GR8	Torque Convertor to Bell Housing
21	M150-535-01	12	LOCK WASHER, M10	Torque Convertor to Bell Housing
22	M350-592-01	1	TRANSMISSION FILTER ASSEMBLY	Not Shown