

CONFIDENTIAL & PROPRIETARY

All data contained in this document is sole property of **DRY SYSTEMS TECHNOLOGIES** and is considered confidential and proprietary. This document may not be reproduced, released to third parties, or used for purposes other than for which it was furnished, without express written consent of **DRY SYSTEMS TECHNOLOGIES**. This document remains property of **DRY SYSTEMS TECHNOLOGIES** and must be returned upon request.

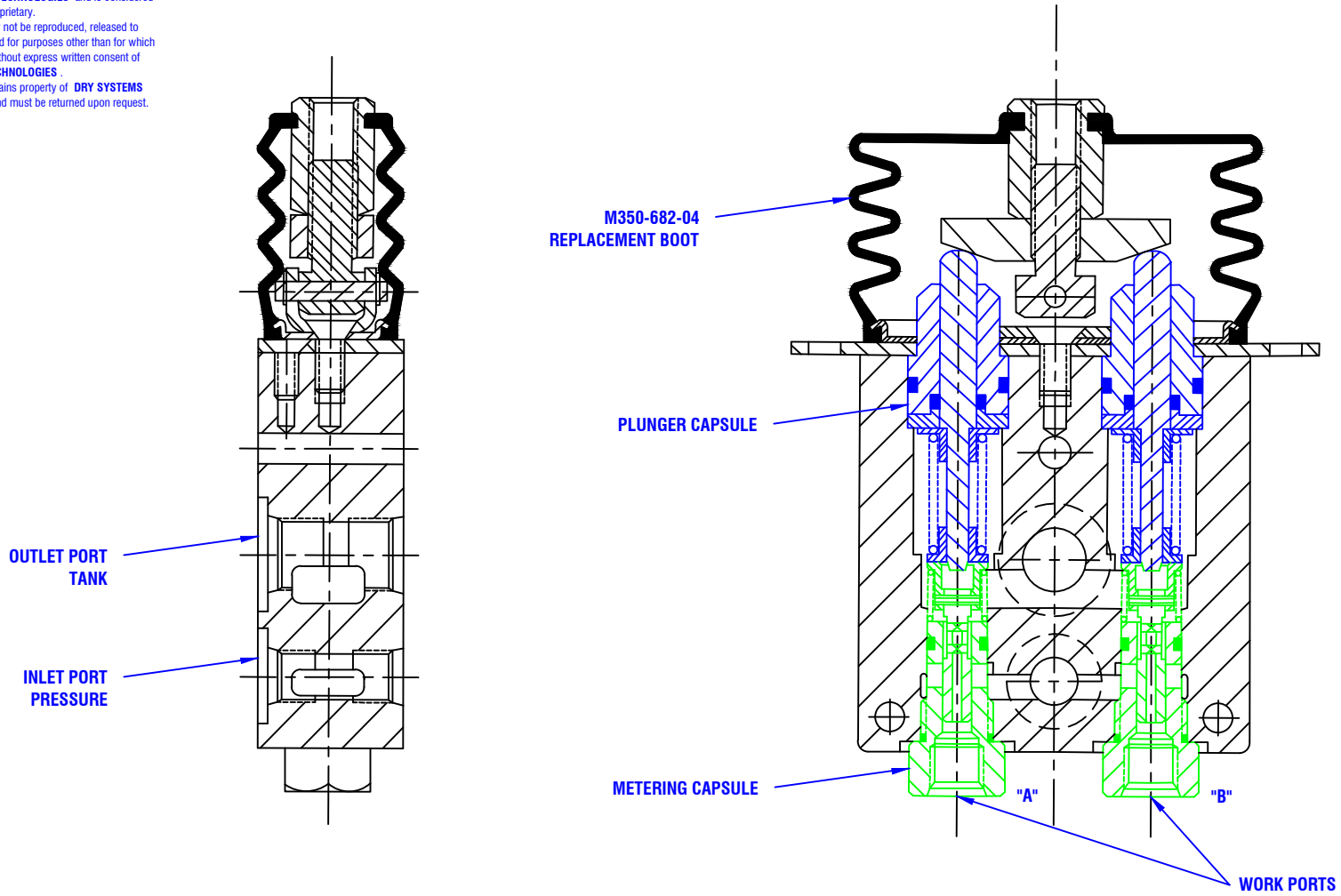

PART NO.	DESCRIPTION
M350-682-05	SEAL KIT FOR PLUNGER CAPSULE
M350-682-06	SEAL KIT FOR METERING CAPSULE

SECTION 3-06

TOLERANCES				
Linear unless noted				
Machined: ±0.005				
Fabricated: ±0.02				
Angular: ±1/2°				
Surface finish 125				
REV	DATE	NAME	DESCRIPTION	

DRY SYSTEMS TECHNOLOGIES
 10420 RISING COURT
 WOODRIDGE, IL 60517
 Phone: 630-427-2051 Fax: 630-427-1036
 E-Mail: eng@dryssystemstech.com

DESCRIPTION	NO RECD
SINGLE LEVER PILOT VALVE ASSY	4
SCALE	DATE
Full	June 2 2015
DRAWN BY	APPROVED BY
W Fox	
MATERIAL	
DRAWING NO	
M350-682-01	

