

**CONFIDENTIAL & PROPRIETARY**

All data contained in this document is sole property of **DRY SYSTEMS TECHNOLOGIES** and is considered confidential and proprietary. This document may not be reproduced, released to third parties, or used for purposes other than for which it was furnished, without express written consent of **DRY SYSTEMS TECHNOLOGIES**. This document remains property of **DRY SYSTEMS TECHNOLOGIES** and must be returned upon request.

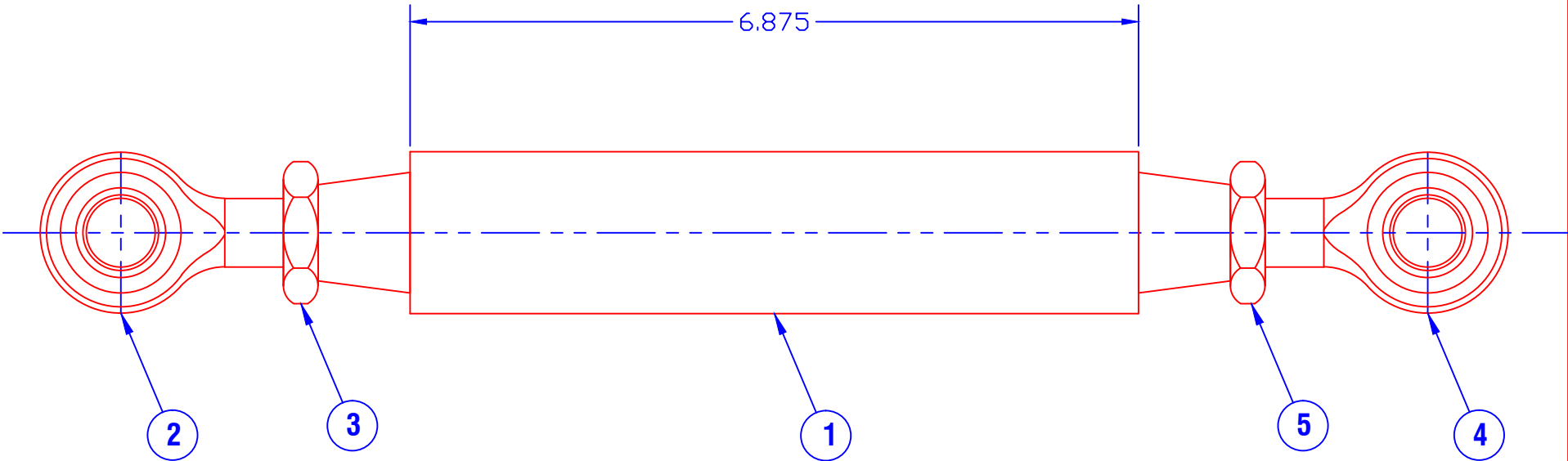

ITEM	PART NUMBER	QUAN.	DESCRIPTION
	<b>M379-525-02</b>	<b>1</b>	<b>FRONT CONTROL ARM ASSEMBLY Includes 1 - 5</b>
<b>1</b>	<b>M379-525-01</b>	<b>1</b>	<b>FRONT CONTROL ARM TUBE</b>
<b>2</b>	<b>M379-520-21</b>	<b>1</b>	<b>BALL JOINT ROD END, RHT</b>
<b>3</b>	<b>M379-520-14</b>	<b>1</b>	<b>JAM NUT, RHT</b>
<b>4</b>	<b>M379-520-19</b>	<b>1</b>	<b>BALL JOINT ROD END, LHT</b>
<b>5</b>	<b>M379-520-15</b>	<b>1</b>	<b>JAM NUT, LHT</b>

**SECTION 3-10**

<b>TOLERANCES</b> Linear unless noted Machined: ±0.005 Fabricated: ±0.02 Angular: ±1/2° Surface finish 125	DRYSYS DATE NAME DESCRIPTION	<b>DRY SYSTEMS TECHNOLOGIES</b> 10420 RISING COURT WOODRIDGE, IL 60517 Phone: 630-427-2051 Fax: 630-427-1036 E-Mail: eng@dryssystemstech.com	DESCRIPTION FRONT CONTROL ARM ASSEMBLY NO RECD 1		
	SCALE Full		DATE Dec. 06 2017		DRAWN BY W Fox
	MATERIAL		APPROVED BY		
	DRAWING NO <b>M379-525-02</b>				