

**CONFIDENTIAL & PROPRIETARY**

All data contained in this document is sole property of **DRY SYSTEMS TECHNOLOGIES** and is considered confidential and proprietary.  
 This document may not be reproduced, released to third parties, or used for purposes other than for which it was furnished, without express written consent of **DRY SYSTEMS TECHNOLOGIES**.  
 This document remains property of **DRY SYSTEMS TECHNOLOGIES** and must be returned upon request.

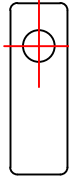

**M350-233-02**  
Base, Driveline

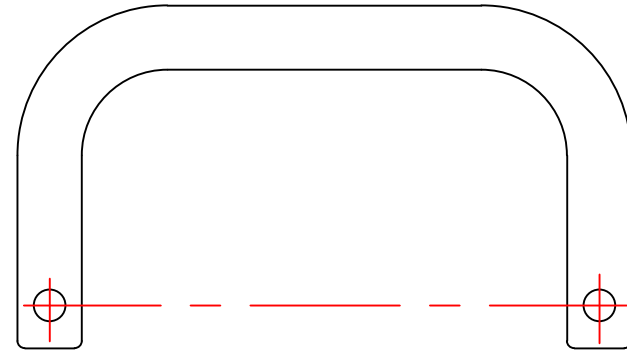

**M350-233-01**  
Guard, Driveline, Articulation

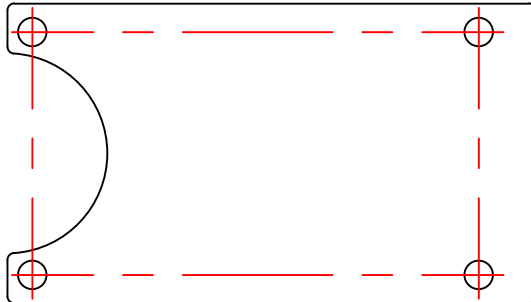

**M350-233-03**  
Mount, Driveline

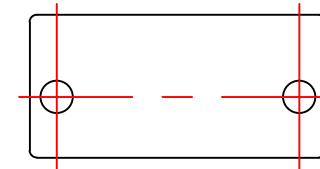

**M350-233-04**  
Base, Driveline

<b>TOLERANCES</b>		<b>DRY SYSTEMS TECHNOLOGIES</b> 8102 LEMONT ROAD, SUITE 700 WOODRIDGE, IL 60517 Phone: 630-427-2051 Fax: 630-427-1036 E-Mail: eng@dryssystemtech.com	<b>DESCRIPTION</b>		DRIVELINE GUARDS M350-233-00
Linear unless noted			DATE	ISSUED BY	
Machined: ±0.005			FIT	MD	
Fabricated: ±0.02			DATE	MAY 2010	
Angular: ±1/2°			APPROVED BY		
Surface finish 125		DATE			

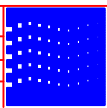

**CONFIDENTIAL & PROPRIETARY**

All data contained in this document is sole property of **DRY SYSTEMS TECHNOLOGIES** and is considered confidential and proprietary.

This document may not be reproduced, released to third parties, or used for purposes other than for which it was furnished, without express written consent of **DRY SYSTEMS TECHNOLOGIES**.

This document remains property of **DRY SYSTEMS TECHNOLOGIES** and must be returned upon request.

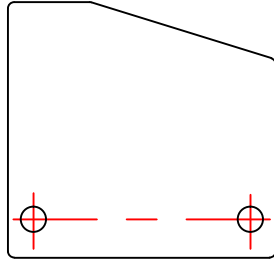

**M350-234-03**  
Base, Driveline, Rear

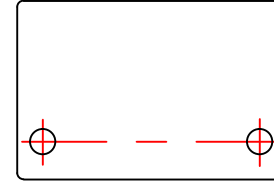

**M350-234-04**  
Base, Driveline, Rear

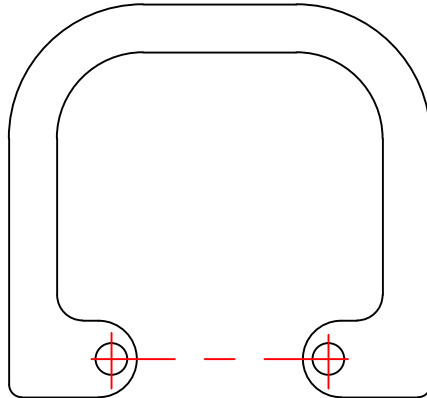

**M350-235-05**  
Guard, Driveline

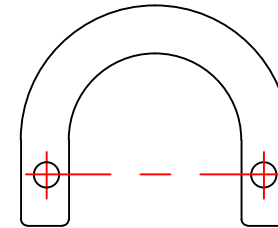

**M350-234-02**  
Guard, Driveline

<b>TOLERANCES</b>		<b>DRY SYSTEMS TECHNOLOGIES</b> 8102 LEMONT ROAD, SUITE 700 WOODRIDGE, IL 60517 Phone: 830-427-2051 Fax: 830-427-1036 E-Mail: eng@drysystemtech.com	<b>DESCRIPTION</b>		DRIVELINE GUARDS M350-234-00
Linear unless noted			DATE	REVISED BY	
Machined: ±0.005			FIT	MB	
Fabricated: ±0.02			DATE	MAY 2010	
Angular: ±1/2°			REVISED BY		
Surface finish 125		DATE			

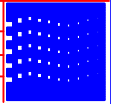

**CONFIDENTIAL & PROPRIETARY**

All data contained in this document is sole property of **DRY SYSTEMS TECHNOLOGIES** and is considered confidential and proprietary.

This document may not be reproduced, released to third parties, or used for purposes other than for which it was furnished, without express written consent of **DRY SYSTEMS TECHNOLOGIES**.

This document remains property of **DRY SYSTEMS TECHNOLOGIES** and must be returned upon request.

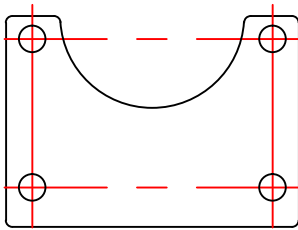

**M350-235-01**  
Mount, Driveline, Front



**M350-235-02**  
Base, Driveline, Front

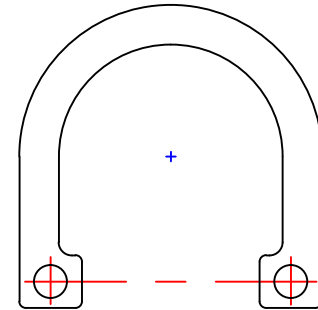

**M350-235-03**  
Guard, Driveline, Front

<b>TOLERANCES</b> Linear unless noted Machined: ±0.005 Fabricated: ±0.02 Angular: ±1/2° Surface finish 125	REV	DATE	DESCRIPTION	<b>DRY SYSTEMS TECHNOLOGIES</b> 8102 LEMONT ROAD, SUITE 700 WOODRIDGE, IL 60517 Phone: 630-427-2051 Fax: 630-427-1036 E-Mail: eng@drysystemtech.com	DESCRIPTION <b>DRIVELINE GUARDS</b>		REV	DATE	
	SCALE	FIT	DATE		DESIGNED BY	APPROVED BY	DATE	BY	
			MAY 2010		MB				
				DRAWING NO. <b>M350-235-00</b>					