

**CONFIDENTIAL & PROPRIETARY**

All data contained in this document is sole property of **DRY SYSTEMS TECHNOLOGIES** and is considered confidential and proprietary. This document may not be reproduced, released to third parties, or used for purposes other than for which it was furnished, without express written consent of **DRY SYSTEMS TECHNOLOGIES**. This document remains property of **DRY SYSTEMS TECHNOLOGIES** and must be returned upon request.

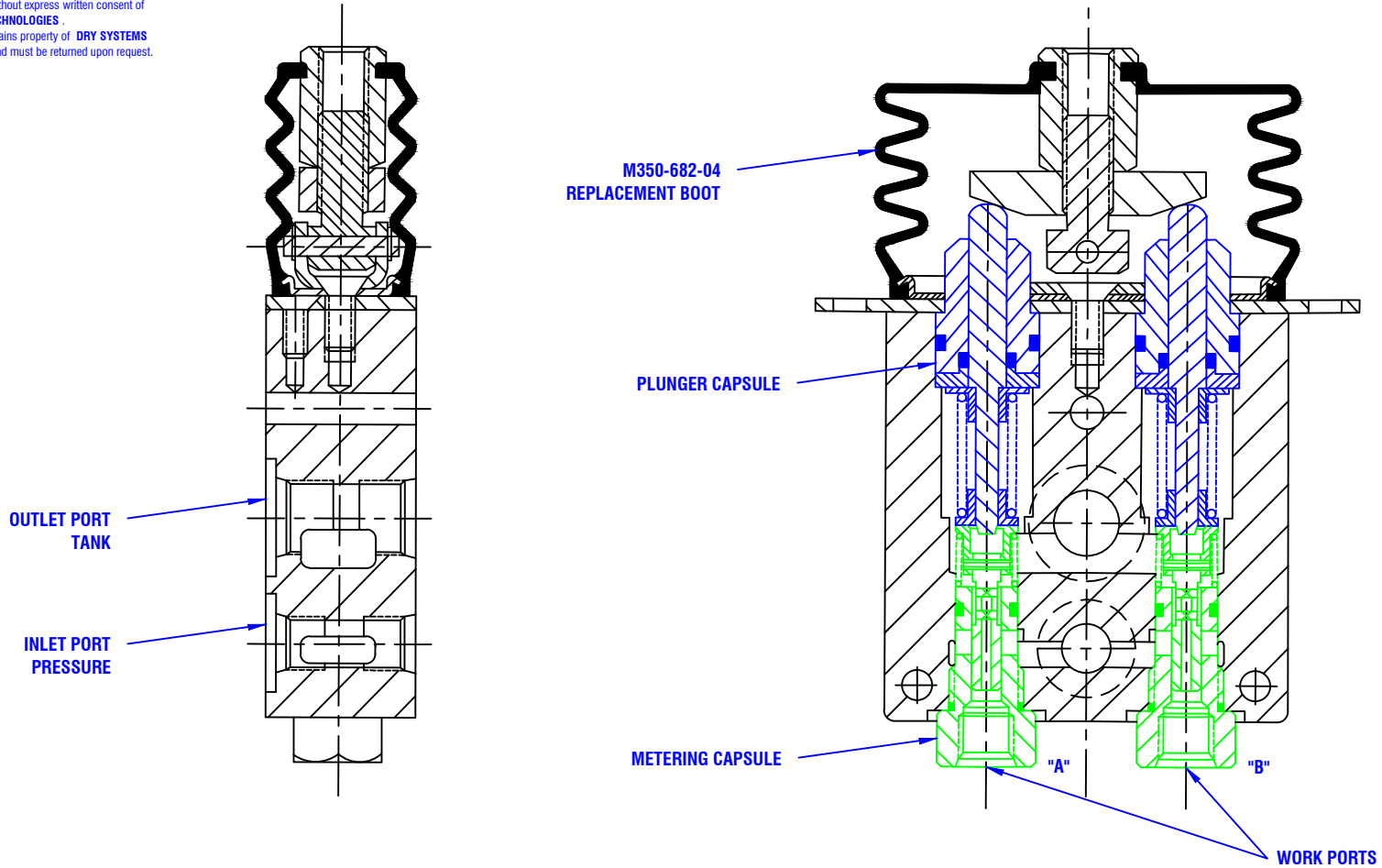

PART NO.	DESCRIPTION
M350-682-05	SEAL KIT FOR PLUNGER CAPSULE
M350-682-06	SEAL KIT FOR METERING CAPSULE

**SN M600001 TO M600030**

**SECTION 5-26**

<b>TOLERANCES</b> Linear unless noted Machined: ±0.005 Fabricated: ±0.02 Angular: ±1/2° Surface finish 125		<b>DRY SYSTEMS TECHNOLOGIES</b> 10420 RISING COURT WOODRIDGE, IL 60517 Phone: 630-427-2051 Fax: 630-427-1036 E-Mail: eng@drysystemstech.com	DESCRIPTION SINGLE LEVER PILOT VALVE ASSY	NO RECD 4	
	SCALE Full		DATE June 2 2015	DRAWN BY W Fox	
				MATERIAL APPROVED BY	
				DRAWING NO <b>M350-682-01</b>	

