

**CONFIDENTIAL & PROPRIETARY**

All data contained in this document is sole property of DRY SYSTEMS TECHNOLOGIES and is considered confidential and proprietary.  
 This document may not be reproduced, released to third parties, or used for purposes other than for which it was furnished, without express written consent of DRY SYSTEMS TECHNOLOGIES.  
 This document remains property of DRY SYSTEMS TECHNOLOGIES and must be returned upon request.

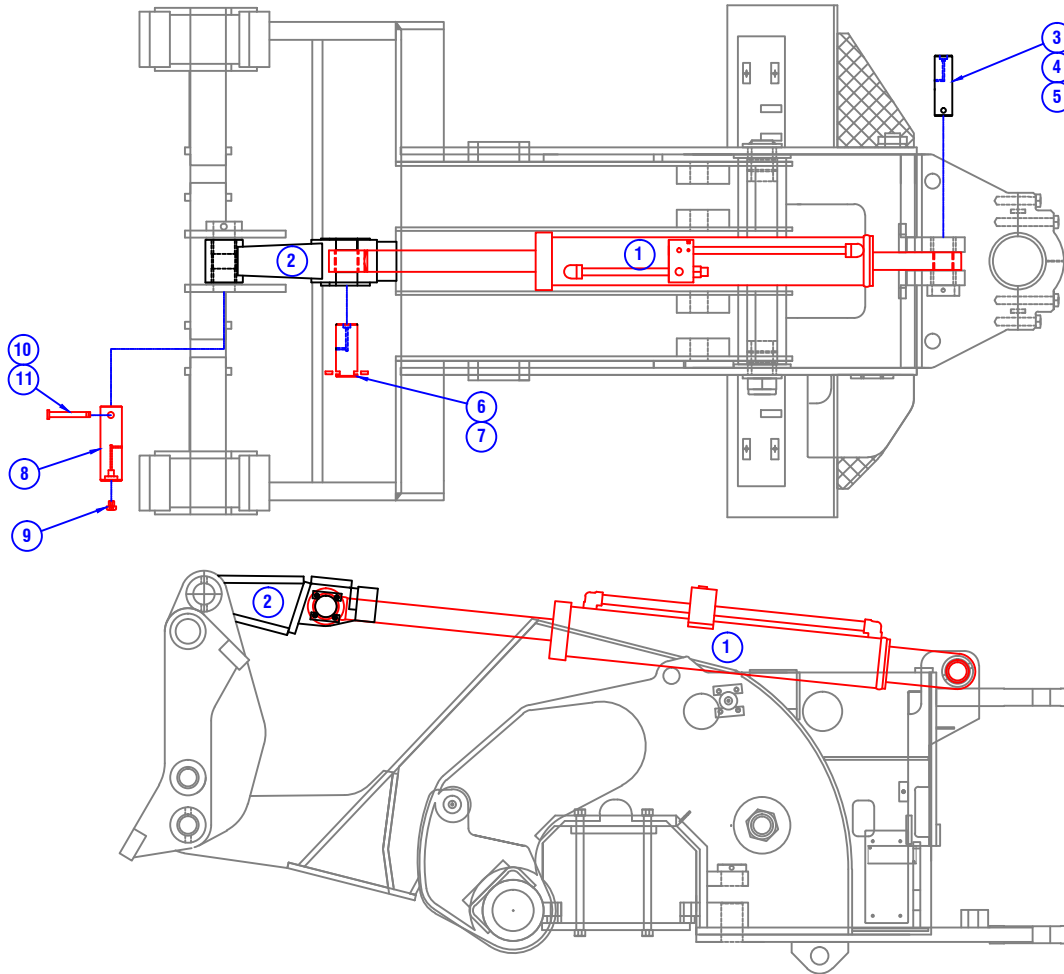

ITEM	PART NUMBER	QUAN.	DESCRIPTION
1	M350-506-12	1	CYLINDER, TILT
1A	M350-506-10	1	CYLINDER, TILT W / LOAD LOCK (ALTERNATE)
2	M350-206-01	1	STABILIZER LINK
3	M350-211-01	1	PIN, TILT CYL TO FRAME
4	M515-500-14	1	HEX HEAD CAPSCREW, 1/2-13 X 5 GR 8
5	M515-560-07	1	NUT, 1/2, TOP LOCK
6	M350-212-01	1	PIN, TILT CYL TO STABILIZER LINK with LOCKS
7	M515-500-03	4	FLAT HEAD SOCKET CAPSCREW, 3/8-16 X 1
8	M350-686-01	1	PIN, QUICK ATTACH
9	M350-686-02	1	GREASE BOLT
10	M350-686-03	1	RETAINING PIN
11		1	COTTER PIN, 5/16 X 1 1/2

**TOLERANCES**

Linear unless noted	
Machined: ±0.005	
Fabricated: ±0.02	
Angular: ±1/2°	
Surface finish 125	

**DRY SYSTEMS TECHNOLOGIES**  
 10420 RISING COURT  
 WOODRIDGE, IL 60517  
 Phone: 630-427-2051 Fax: 630-427-1036  
 E-Mail: [eng@dryssystemstech.com](mailto:eng@dryssystemstech.com)

DESCRIPTION	TILT CYLINDER INSTALLATION	NOTES	1
SCALE	Full	DATE	April 29 2015
DESIGNED BY	W FOX	APPROVED BY	
DRAWING NO.	<b>SECTION 5-38</b>		

